

The Improvement contains about thirty five acres a house Barn & some fruit trees the settlement was commenced in July 1800 and is Continued

Thomas King

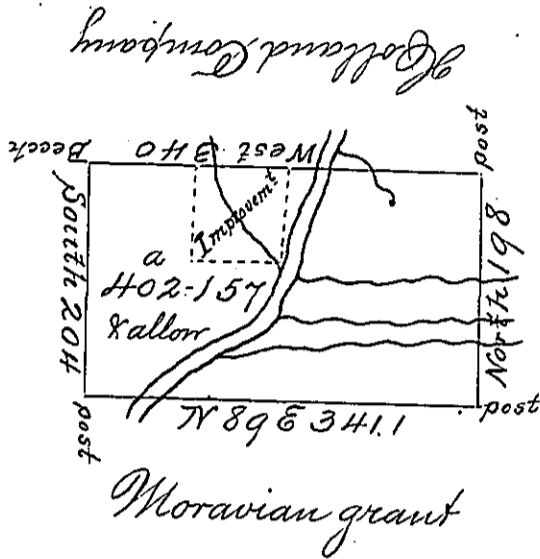

Andrew Simpson

A Draught of a tract of Land situate on the Waters of French Creek in Waterford Township Erie County Surveyed the 12th Day of April 1816 for Alexander M. Elroy on his Warrant dated March 6th 1816 Containing Four Hundred & Two acres & one hundred & Fifty seven perches & the allowance of six per Cent &c.

To Rich^d T. Leech, Esq
Surveyor General

Jonah Cowgill of

IN TESTIMONY that the above is a copy of the original remaining on file in the Department of Internal Affairs of Pennsylvania, made conformably to an Act of Assembly approved the 16th day of February, 1833, I have hereunto set my Hand and caused the Seal of said Department to be affixed at Harrisburg, this seventh day of October 1902.

James W. Fetter
Secretary of Internal Affairs.